



KCM-WF 3/8" + 1/2" + 5/8"

2194796-10.2024

100

KWIK CAST
KCM-WF 3/8" + 1/2" + 5/8"
RED-BLK
#2193290

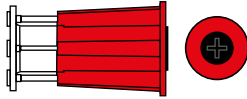

Info | Shop



qr.hilti.com/2193290

Batch Tracking
Information

Made in Taiwan
Hilti = trademark of Hilti Corp., Schaun, LI

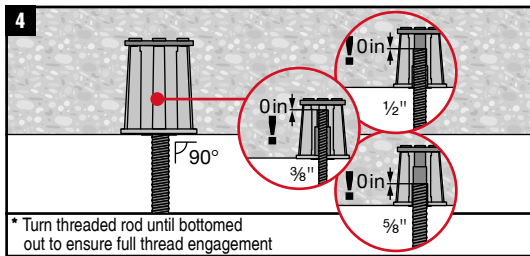
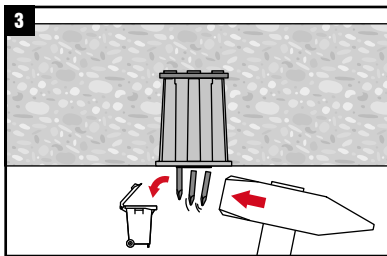
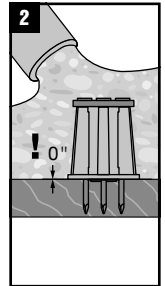
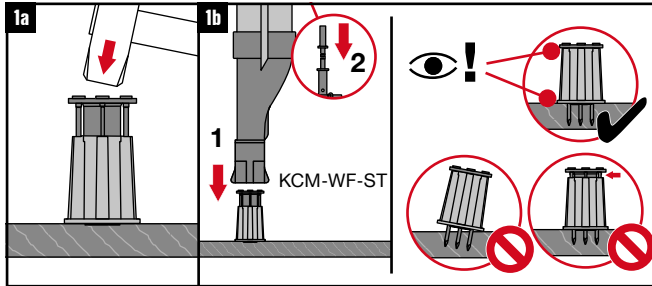
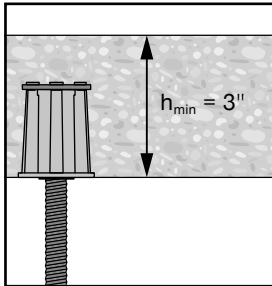

* Turn threaded rod until bottomed out to ensure full thread engagement

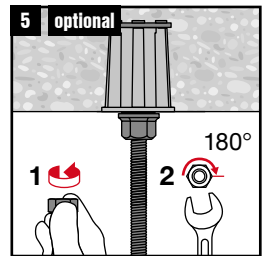

Maximum pipe size allowed for the 3/8-inch Rod Size is 8 NPS.