

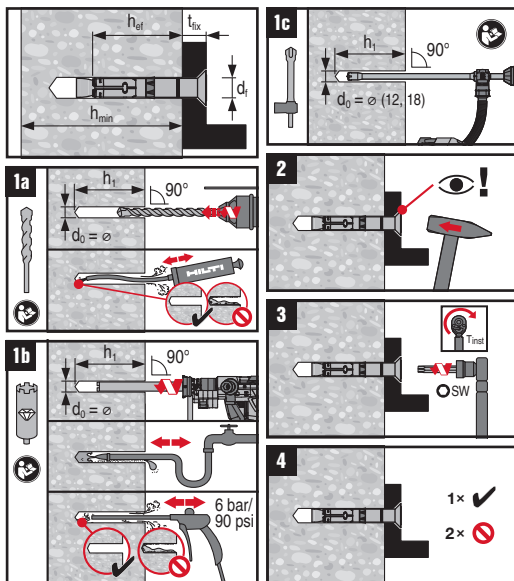

HSL4-SK

2246193 A1-09.2019



HSL4-SK	t <sub>ex</sub> (mm)	h <sub>ef</sub> (mm)	h <sub>min</sub> (mm)	h <sub>1</sub> (mm)	d <sub>0</sub> (mm)	d <sub>i</sub> (mm)	T <sub>inst</sub> (Nm)	○
M8 ø12x80	6...10	60	120	80	12	14	20	SW5
M8 ø12x90	6...20							
M10 ø15x100	6...20	70	140	90	15	17	32	SW6
M12 ø18x120	8...25	80	160	105	18	20	65	SW8